

2-WAY, 0°, 1000-2000 MHz , DC BLOCK/LOAD ALL PORTS

## WEATHERPROOF

- WEATHERPROOF (IP67)
- GNSS (GPS, GALILEO, GLONASS, ETC)
- TWO (2) PORTS BLOCK DC W/200Ω INTERNAL LOAD
- HIGH ISOLATION (>25 dB AVG)

- OUTDOOR
- GPS (US)
- GLONASS (RU)
- IRNSS (IN)
- GALILEO (EU)
- BEIDOU (CN)
- QZSS (JP)
- GNSS/L-BAND

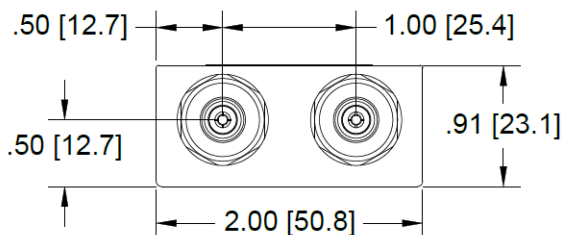

## ELECTRICAL

FREQUENCY (MHz)	1000 - 2000
IMPEDANCE	50 $\Omega$
INSERTION LOSS (dB)	0.4 MAX (ABOVE -3.01 dB SPLIT)
AMPLITUDE BALANCE (dB)	0.2 MAX
PHASE BALANCE (DEG)	4 MAX
ISOLATION (dB)	25 MIN
VSWR (PORT S)	1.20:1 MAX
VSWR (PORT 1,2)	1.20:1 MAX
VDC (VOLTS)	15 MAX
DC CURRENT (mA)	75 MAX

1.0

2) AS COMBINER OF NON-COHERENT SIGNALS, MAX INPUT POWER PER PORT.



CONNECTORS  
CONTACT PINS  
HOUSING  
INSULATOR  
O-RING/GASKET  
TEMPERATURE  
WEIGHT

N JACK, BRASS, TRI-ALLOY PLATE  
PHOSPHOR BRONZE, GOLD PLATE  
ALUMINUM, CHEMICAL FILM  
PTFE, VIRGIN ELECTRICAL GRADE  
SILICONE RUBBER  
-55°C TO +85°C  
200 GRAMS

**AdvancedRF**