

# POWER SPLITTER/COMBINER

2-WAY, 0°, 698-2700 MHz

# MODEL W2N0727

WEATHERPROOF

## FEATURES

- BROADBAND, 698-2700 MHz
- WEATHERPROOF (IP67)
- LOW INSERTION LOSS (0.2 AVG)
- HIGH ISOLATION (>25 dB AVG)

## APPLICATIONS

- OUTDOOR
- 4G/LTE
- L-BAND
- WIMAX
- PCS/DCS/UMTS
- GSM
- DAS
- AND MORE

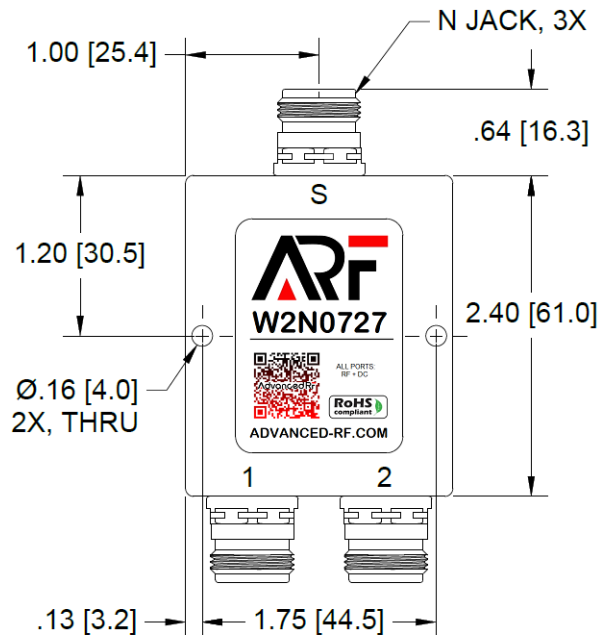

## ELECTRICAL

FREQUENCY (MHz)	698 - 2700
IMPEDANCE	50 Ω
INSERTION LOSS (dB)	0.4 MAX (ABOVE -3.01 dB SPLIT)
AMPLITUDE BALANCE (dB)	0.1 MAX
PHASE BALANCE (DEG)	1 MAX
ISOLATION (dB)	22 MIN
VSWR (PORT S)	1.25:1 MAX
VSWR (PORT 1,2)	1.20:1 MAX

### RF POWER RATING (WATTS)

AS SPLITTER <sup>1</sup>	AS COMBINER <sup>2</sup>
50	1.0

- 1) ALL OUTPUT PORTS MUST TERMINATE 50 OHM (LOAD VSWR 1.20:1 OR BETTER).
- 2) AS COMBINER OF NON-COHERENT SIGNALS, MAX INPUT POWER PER PORT.

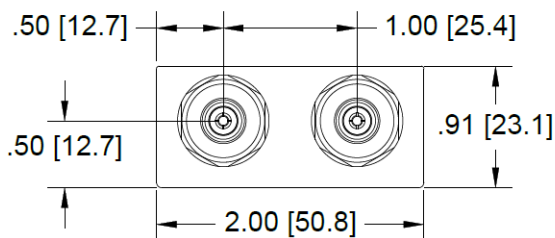

OUTLINE DIMENSIONS: INCH [MM]

## MECHANICAL

CONNECTORS	N JACK, BRASS, TRI-ALLOY PLATE
CONTACT PINS	PHOSPHOR BRONZE, GOLD PLATE
HOUSING	ALUMINUM, CHEMICAL FILM
INSULATOR	PTFE, VIRGIN ELECTRICAL GRADE
O-RING/GASKET	SILICONE RUBBER
TEMPERATURE	-55°C TO +85°C
WEIGHT	200 GRAMS

**AdvancedRf** weatherproof power splitter/combiner model W2N0727 is a microstrip Wilkinson power divider circuit optimized to provide industry leading performance from 698 - 2700 MHz for outdoor applications. IP67 ingress protection provides confidence for critical applications in tough environments. Also available with DC blocking options (W2NDC01 and W2NDC02). All Advanced RF weatherproof power splitter/combiner models can be easily installed in our 19" EIA 1U-5U rack panels - providing flexible configuration options. RoHS compliant. Call 984-409-0029 today and speak with a sales engineer regarding your application.

# AdvancedRf